

**Assembly and installation manual**

# Anti-Wind Mosquito Screen Premium 65



# Table of contents

<b>1. Components</b>	<b>3</b>
1.1 Premium anti-wind mosquito screen cutting - motorized	3
1.2 Premium anti-wind mosquito screen cutting - manual	4
1.3 Profiles	5
1.4 Accessories	5
<b>2. Manufacturing dimensions</b>	<b>6</b>
2.1 Maximum/minimum dimensions - motorized	6
2.2 Maximum/minimum dimensions - manual	6
<b>3. Cutting and selection tables</b>	<b>6</b>
3.1 Allowances	6
3.2 Fabric production measurements	7
3.3 Number of equalizer spring turns	7
<b>4. Assembly instructions</b>	<b>8</b>
4.1 Axle assembly and configuration	8
4.2 Terminal assembly	9
4.3 Box assembly	10
<b>5. Installation instructions</b>	<b>11</b>
<b>6. Wind resistance (UNE-EN 13659:2004+A1:2008)</b>	<b>13</b>

## Important

It is important for the safety of persons and the integrity of the product to read these instructions carefully before installing, operating, repairing or using the mosquito screen for the first time.

This document is an integral part of the titled mosquito screen model and is intended for the installer. It contains specific information regarding its cutting and a complete guide of the sequence of operations for its assembly and installation.

It also contains information required to give presumption of conformity with the European Construction Products Directive and European Standard EN 13561:2004+A1:2008 as regards accompanying documents.

Information on general requirements for the use, handling, installation, maintenance and disposal of the mosquito screen can be found in the document **"Mosquito screens: prescriptions for the user and installer"** available at [saxun.com](http://saxun.com).

**Both documents constitute a complete instruction manual** and are an essential tool to properly operate your mosquito screen throughout its the life cycle: installation, use, maintenance and disposal at the end of its useful life.

We recommend that you download both documents and keep them linked to the mosquito screen for future reference. The information they contain is an essential part of the product.

## 1. Components

### 1.1 Premium anti-wind mosquito screen cutting - Motorized

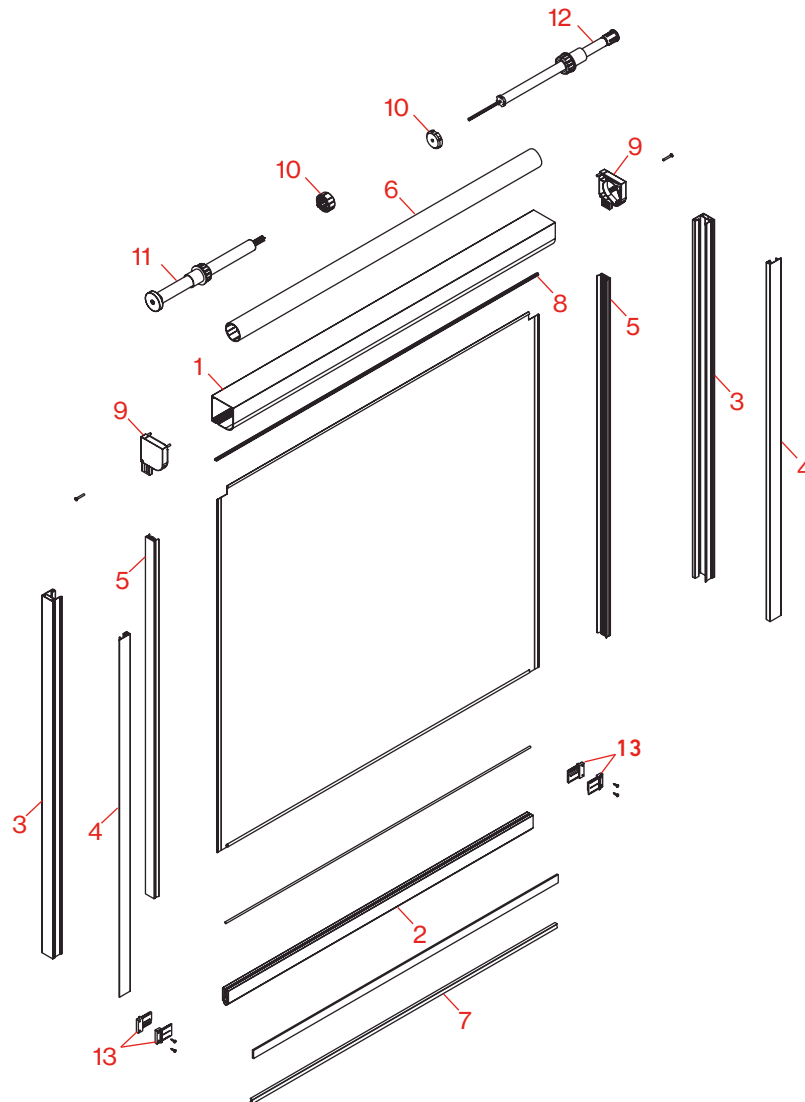

Ref.	Description
1	100153 Box profile 65
2	100150 Terminal 33.5x18 mm
3	100152 Clipable Premium Lower Guide
4	100151 Clipable Premium Upper Guide
5	024179 Zipper guide profile 26x13.50 mm
6	030501 Aluminium tube 45 mm
7	041068 Brush Ref.: 69-1000

Ref.	Description
8	026005 Brush Ref.: 38-550
9	100157 Set of 65mm box end caps
10	100159 Motor Kit - Anti-wind Premium 65
11	502599 Motor Roll Up Wirefree RTS
12	030509 Mosquito Screen Spring 65 axle of 25 - Right
13	100114 Set of Terminal end caps 33.5x18 mm

## 1.2 Premium anti-wind mosquito screen cutting - Manual

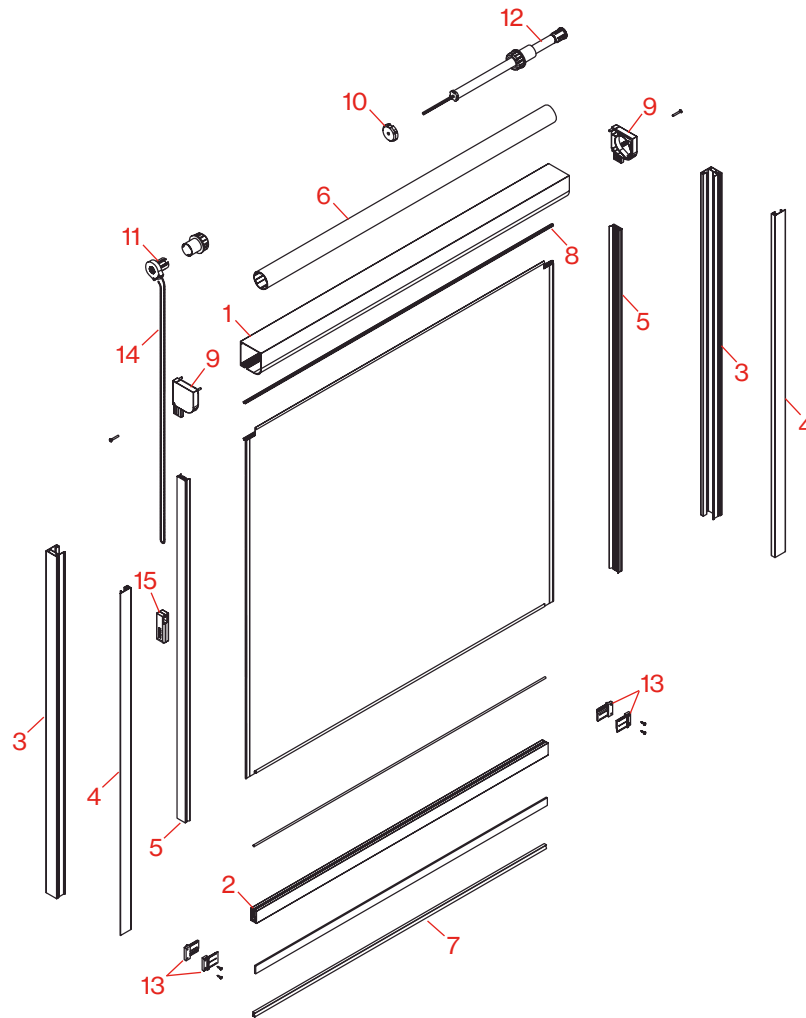

	Ref.	Description
1	100153	Box profile 65
2	100150	Terminal 33.5x18 mm
3	100152	Clipable Premium Lower Guide
4	100151	Clipable Premium Upper Guide
5	024179	Zipper guide profile 26x13.50 mm
6	030501	Aluminium tube 45
7	041068	Brush Ref.: 69-1000
8	026005	Brush Ref.: 38-550

	Ref.	Description
9	100157	Set of box end caps 65
10	100158	Mechanism kit - Anti-wind Premium 65
11	030405	Tilt chain mechanism- Axle 25
12	030509	Mosquito Screen Spring 65 axle of 25 - Right
13	100114	Set of Terminal end caps 33.5x18 mm
14	034024	4.5x6 mm PVC Chain (Saxun)
15	030425	Complete Slim L Tensor

### 1.3 Profiles

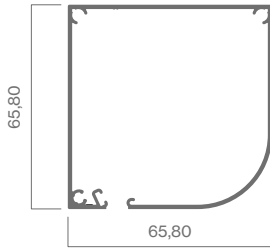

<b>100153</b>	Box profile 65
---------------	----------------

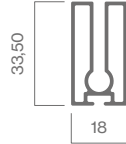

<b>10A0150</b>	Terminal 33.5x18 mm
----------------	---------------------

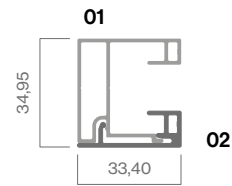

<b>100152</b> <b>100151</b>	01. Clipable Premium Lower Guide 02. Clipable Premium Upper Guide
--------------------------------	--



<b>024179</b>	Rack and pinion guide 26x13.50 mm
---------------	-----------------------------------



<b>026005</b>	Brush Ref.: 38-550
---------------	--------------------



<b>041068</b>	Brush Ref.: 69-1000
---------------	---------------------

### 1.4 Accessories



<b>100157</b>	Set of box end caps 65
---------------	------------------------



<b>10A0150</b>	Motor Kit - Anti-wind Premium 65
----------------	----------------------------------



<b>100114</b>	Set of Terminal Caps 33,5x18
---------------	------------------------------



<b>100158</b>	Mechanism kit - Anti-wind Premium 65
---------------	--------------------------------------



<b>030509</b> <b>030978</b>	Mosquito screen spring 65 axis 25 - Right Mosquito screen spring 65 axis 25 - Left
--------------------------------	---



<b>503351</b> <b>503308</b>	Motor Roll Up RTS 12V Ac/DC Transformer
--------------------------------	--

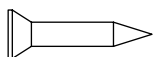

<b>507040</b>	Screw DIN 7982 3.2x50 mm
---------------	--------------------------



<b>030405</b>	Tilt chain mechanism- Axle 25
---------------	-------------------------------



<b>006283</b>	Screw DIN 7505 2,50x12 mm
---------------	---------------------------

## 2. Manufacturing dimensions

### 2.1 Maximum/minimum dimensions - Motorized mosquito screen

Maximum		Minimum	
Width	<b>1,80 m</b>	Width Motor radius	<b>0,80 m</b>
High	<b>1,60 m</b>	High	-

### 2.2 Maximum/minimum dimensions - Manual mosquito screen

Maximum		Minimum	
Width	<b>1,80 m</b>	Width	<b>0,50 m</b>
High	<b>1,60 m</b>	High	-

## 3. Cutting and selection tables

### Important

When cutting profiles, take into account the allowance tables.

The allowances are always made from the total dimensions (equivalent to the opening where it will be installed).

X = Total width (mm)

Y = Total height (mm)

### 3.1 Allowances

Componentes	mm
Box profile 65	<b>X -28</b>
Terminal 33.5x18 mm	<b>X -82</b>
Clip-on front guide	<b>Y -66</b>
Clip-on rear guide	<b>Y -66</b>
Rack and pinion guide profile 26x13.50 mm	<b>Y -68</b>
Aluminium tube 45 mm	<b>X -92</b>
Brush Ref. 69-1000	<b>X -82</b>
Brush Ref. 38-550	<b>X -28</b>

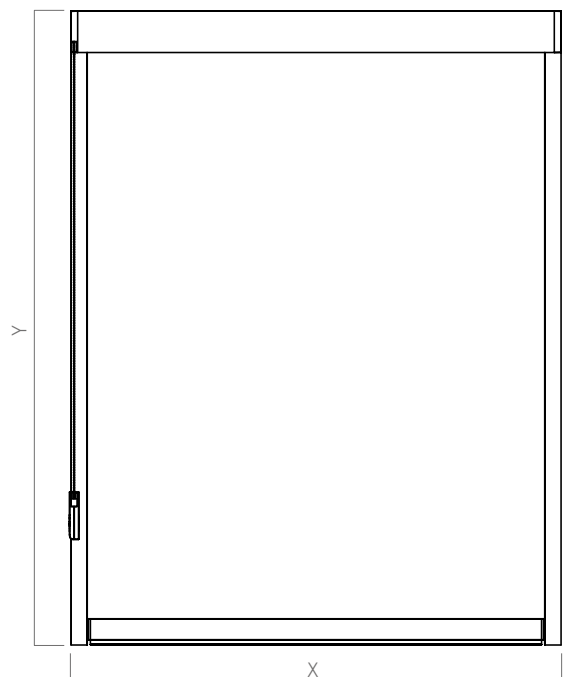

### 3.2 Fabric production measurements

Dimensions	mm
High	<b>+150</b>
Width without zipper	<b>-56</b>
Width with zipper	<b>-48</b>

#### Important

For the cutting of the fabric it is necessary to take into account the measurement chart, according to the size of the box. Dimensions are always total and are expressed in mm.

The fabric is put together as per the plan.

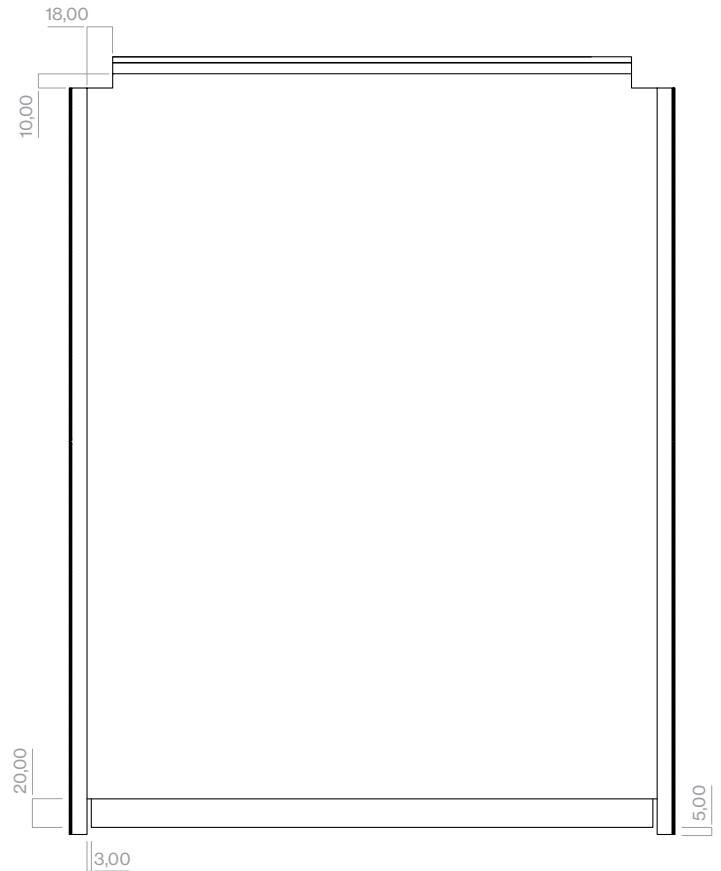

### 3.3 Number of tension spring turns

Width / height (m)	1,00	1,10	1,20	1,30	1,40	1,50	1,60	1,70	1,80	1,90	2,00
1,00	<b>6</b>	<b>7</b>					<b>9</b>			<b>10</b>	
1,10											
1,20											
1,30											
1,40											
1,50											
1,60											
1,70											
1,80											
1,90											
2,00											
2,10											
2,20											
2,30											
2,40											

## 4. Assembly instructions

### 4.1 Axle assembly and configuration

#### Important

Depending on the drive system, the axle must be configured differently.

In the following exploded-view diagram, the various parts required can be seen. The tables show the parts and the required quantities of each one, following the assembly order from left to right.

The drawings are schematic so as to distinguish the order of the pieces. When you start assembly, insert the fabric in the axle before starting to assemble the rest of the pieces.

#### 4.1.1 Premium anti-wind mosquito screen axle configuration - Motorized

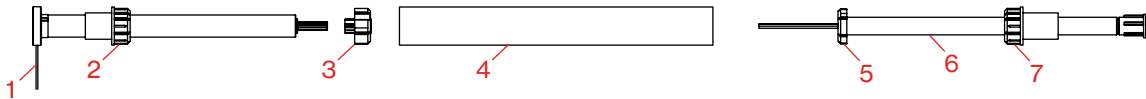

	Description	ud.
1	Motor Roll Up Wireless RTS	1
2	* Motor fixing screw	1
3	* Drive wheel	1

	Description	ud.
4	Aluminium tube 45	1
5	* Spring wheel	1

	Description	ud.
6	Mosquito screen Spring 65	1
7	* Spring fixing screw	1

\* The pieces with an asterisk are part of the article 100159 (Motor kit - Anti-wind premium 65). This item can not be divided, if you need a separate piece, you must buy it complete.

#### 4.1.2 Premium anti-wind mosquito screen axle configuration - Manual

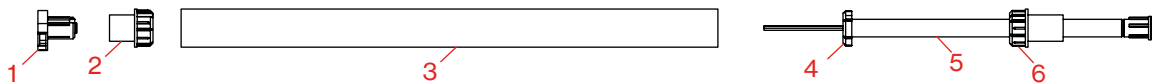

	Description	ud.
1	Tilt chain mechanism- Axle 25	1
2	* Mechanical fixing screw	1

	Description	ud.
3	Aluminium tube 45	1
4	* Spring wheel	1

	Description	ud.
5	Mosquito screen Spring 65	1
6	* Spring fixing screw	1

\* The pieces with an asterisk are part of the article 100158 (Mechanism kit - Anti-wind Premium 65). This item can not be divided, if you need a separate piece, you must buy it complete.



### 4.1.3 Axle assembly

#### Step 1

Insert the fabric into the axle.

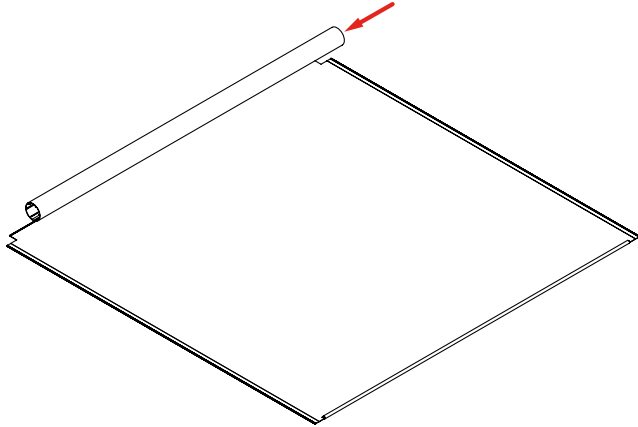

#### Step 2

Depending on the drive system, configuring the axle as indicated in **section 4.1**.

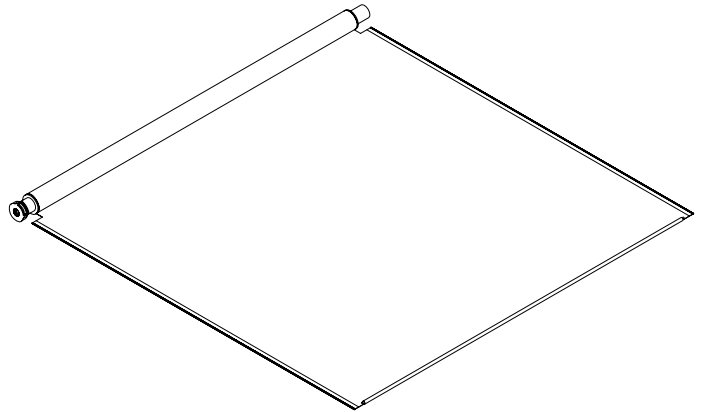

#### Step 3

Roll the screen onto the axle.

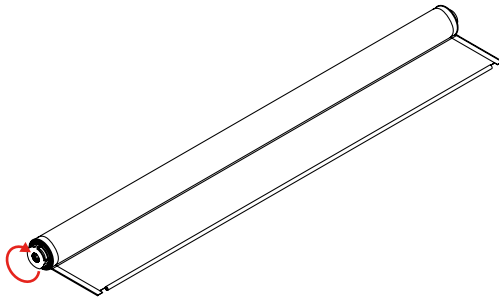

### 4.2 Terminal assembly

#### Step 1

Insert the screen and the brush (Ref. 69-1000) into the terminal.

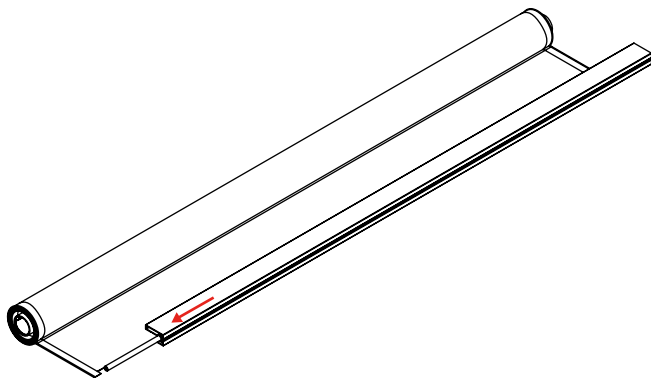

#### Step 2

Join the plug set with the terminal. The screen stays between the two parts of the stopper. Connect both parts using the DIN screw 7505 2,5x12 mm.

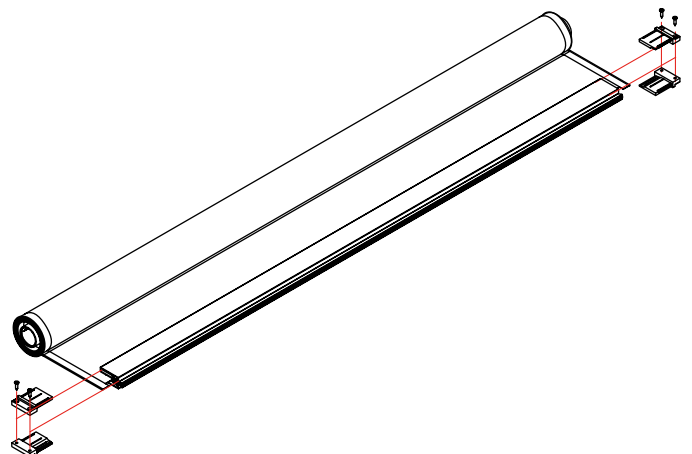

### 4.3 Box assembly

#### Step 1

Insert the brush (Ref. 38-550) into the box profile.

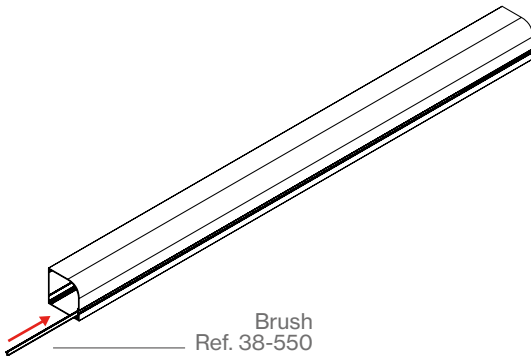

#### Step 2

Insert the axle with the screen rolled up and the terminal that is fixed to the screen into the inside of the box profile.

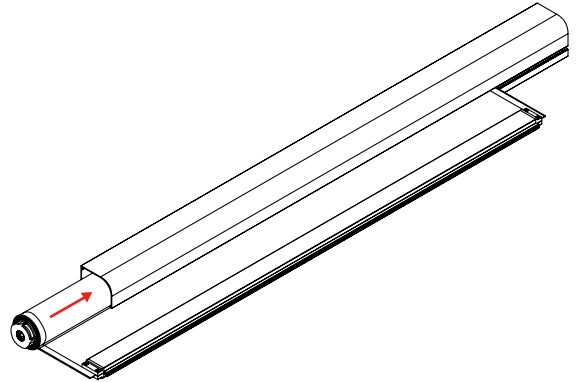

#### Step 3

Insert the end plate pivot into the spring housing. Carefully load the spring in the right direction.

Then simultaneously connect the end cap and the spring to the drawer profile and fix it with the screw.

Spring load:

- Left spring - Clockwise rotation
- Right spring - Anti-clockwise rotation

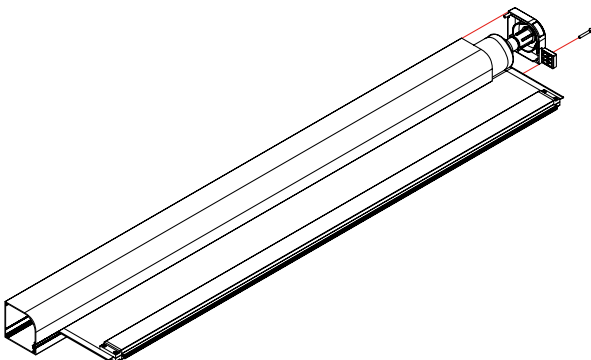

#### Step 4

Finish the assembly of the drawer by coupling the opposite end piece to the one already installed and fix it with the screw.

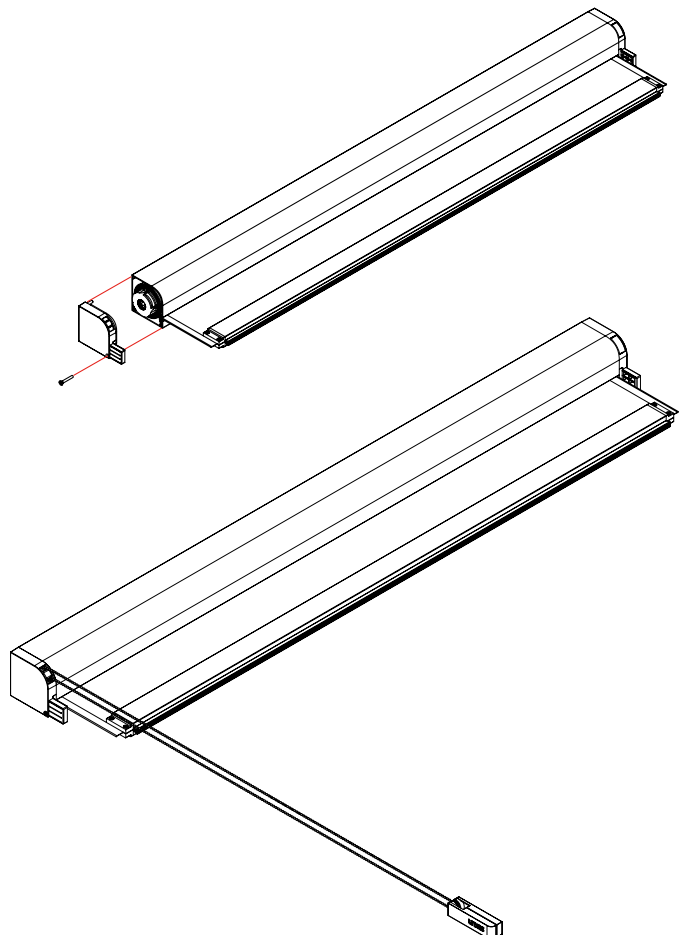

## 5. Installation instructions

### Step 1

Check the dimensions of the place where it is to be installed.

X = Total width (mm)

Y = Total height (mm)

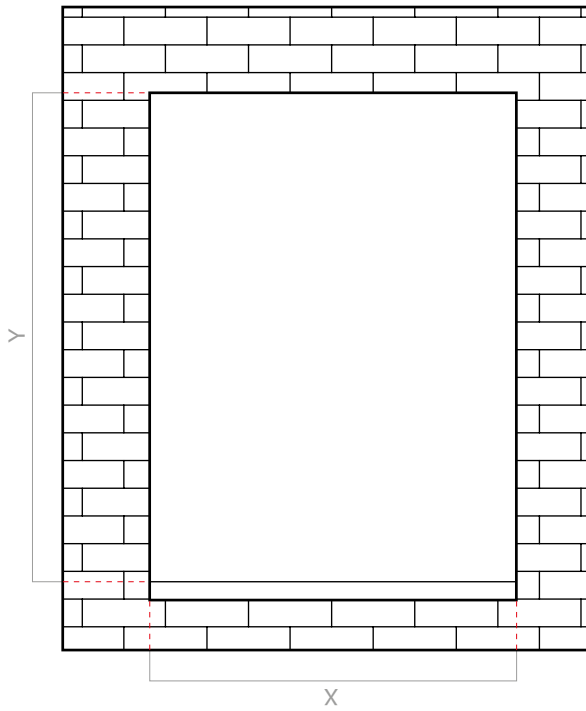

### Step 2

Check the dimensions of the product before installation. Check that they are correct.

X = Total width (mm)

Y = Total height (mm)

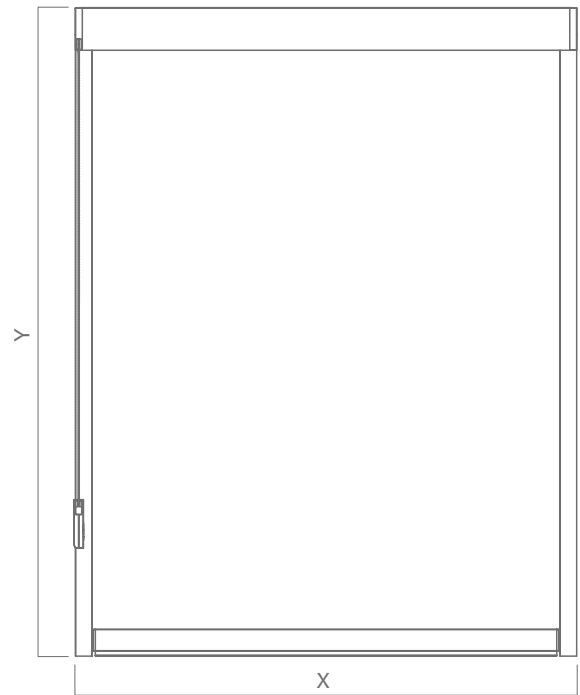

### Step 3

Join the box with the rear guides. Insert the end plating footing through the housing of the rear guide.

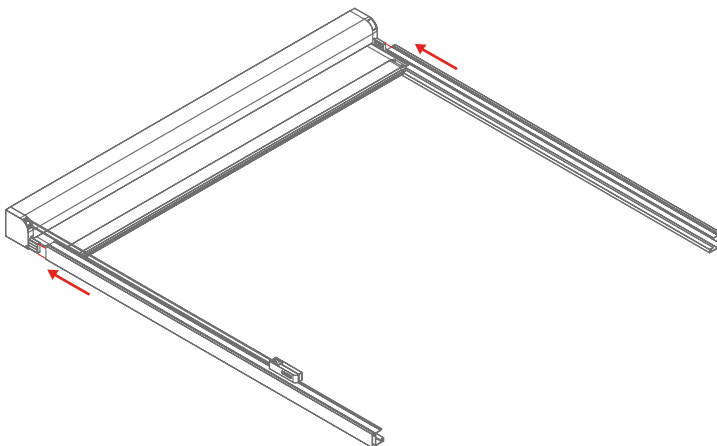

### Step 4

Check that the product has been correctly levelled and squared in all positions.

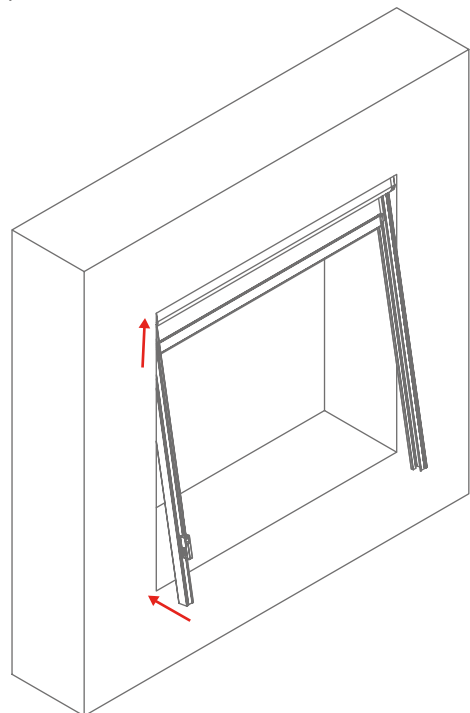

### Step 5

Check that the product has been correctly levelled and squared in all directions.

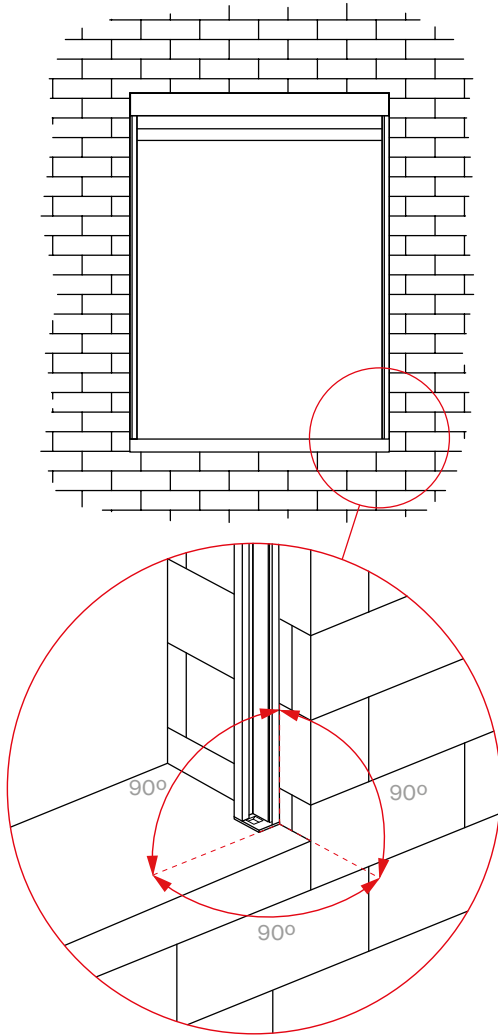

### Step 6

Fix the system using the guides. Take the type of wall into account when choosing the fixing method.

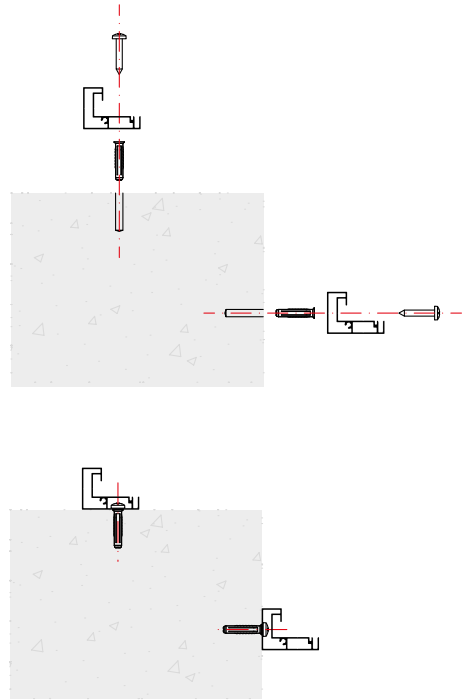

### Step 7

Clip the two aluminium profiles that make up the guide.

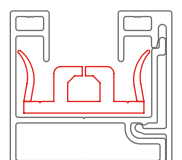
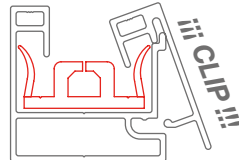
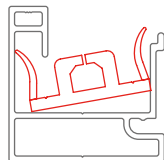
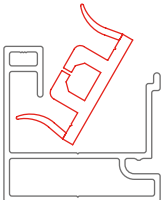

## 6. Wind resistance (UNE-EN 13659:2004+A1:2008)

<b>Classes</b>							
	<b>0</b>	<b>1</b>	<b>2</b>	<b>3</b>	<b>4</b>	<b>5</b>	<b>6</b>
Nominal test pressure (Pa) or (N/m <sup>2</sup> )	<50 Pa	50 Pa	70 Pa	100 Pa	170 Pa	270 Pa	400 Pa
Test safety pressure 1.5 (Pa) or (N/m <sup>2</sup> )	<75 Pa	75 Pa	100 Pa	150 Pa	250 Pa	400 Pa	600 Pa
Nominal speed (Km/h)	<33	≈ 33	≈ 38	≈ 46	≈ 60	≈ 76	≈ 92
Safety speed (Km/h)	<40	≈ 40	≈ 46	≈ 56	≈ 73	≈ 92	≈ 112

**saxun**  
by Giménez Ganga

**Giménez Ganga, S.L.U.**  
Polígono Industrial El Castillo  
C/ Roma, 4  
03630 • Sax (Alicante) • España

**saxun.com**